

LEW'S LASER[®] SPEED SPOOL[®]

LS1H, LS1SH

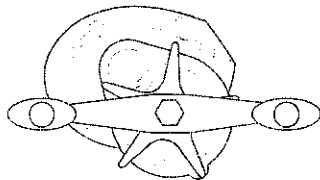

Speed Spool Bait Cast reels are designed to be **Lighter, Faster and Stronger**

Driven by innovation – Fueled with Passion
Feel the Difference!

LASER[®]
SPEED SPOOL[™] LS1H, LS1SH

Reel Specifications

Model	Weight	Gear Ratio	Max Drag	Line Capacity	IPT
LS1H	7.2 OZ.	6.4:1	10 lb.	12 lb./120 yds.	28"
LS1SH	7.2 OZ.	7.1:1	10 lb.	12 lb./120 yds.	31"

FEATURES:

- Lightweight Graphite Frame and Side Plates
- 6 Bearing System (5+1)
- 4-pin Centrifugal Braking System
- Anodized High Grade Aluminum Spool
- Durable Rulon Star Drag System with 10 lb. Max Drag Setting
- Aluminum Handle

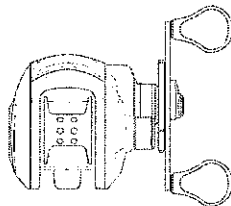

Designed Performance

Our new bait-cast reel by Lew's is designed for performance and functionality. From the way it conforms to your hand, to the way it reacts crisply and effortlessly to your command, you'll know the minute you grab onto the Speed Spool[®] that you've got a quality reel.

Your Speed Spool[®] reel exploits several new developments which will allow you to set yourself apart from the competition.

High Strength Brass Gearing

The drive gear, crankshaft, and worm shaft are made of high strength brass for increased strength and durability. In addition to these advantages, brass provides exceptionally low friction to enhance efficiency.

Lightweight Graphite Frame

The one-piece graphite frame design makes this reel lightweight, yet still very strong.

Lightweight Machined Aluminum Spool

Machined Aluminum Spool 

The spool on your Lew's reel has been engineered to maximize casting distance. Anodized to withstand oxidation and abrasion, the lightweight machined aluminum spool with drilled holes to further reduce inertial mass will allow you to propel your lure farther than the competition – and you'll have a greater degree of control with less standing between you and the fish.

Anti-reverse Bearing

The handle on your Speed Spool[®] reel will only rotate forward for rock solid hook setting power. When you release the handle it will hold its position because of anti-reverse bearings, never losing an inch on your catch; an invaluable property to have when you're pulling it in.

6 Bearings System

Centrifugal Brake System

In order to combat backlash your Speed Spool[®] reel is furnished with a centrifugal brake system. As the spool accelerates it experiences friction by four internal brake shoes which slide outwards when engaged. To disengage individual brake shoes remove the palming side-plate. The four brake shoes are housed within a disk attached to the spool assembly. When disengaged the brake shoes remain stationary when the spool spins and do not inflict friction on the spool.

Centrifugal Brake System **CBS**

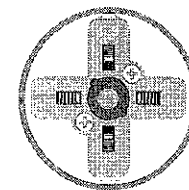

Cast Control System

A second feature exists to prevent backlash, the Cast Control System. An adjustment knob is found next to the star drag. The function saddles the spool shaft with steady pressure in order to stabilize spool speed.

To calibrate the system reel your lure in until it rests on the tip of the rod, then tighten the knob until taut. Depress the thumb bar, and holding the rod horizontally loosen the knob slowly until the lure begins to descend. The spool should continue to spin after the lure contacts the ground, but should not complete more than one full rotation. If the spool does not continue to spin, the knob is too tight. If the spool completes more than one rotation, the knob is too loose. Repeat until you have achieved the desired results.

LASER[®]

SPEED SPOOL[®] LS1H, LS1SH

One Year Limited Warranty

Maintenance and Care

To remove the palming side plate, loosen screw, pull plunger back then rotate palming side plate up. When applying lubricant to your Speed spool[®] reel, avoid using multi-purpose oil. Use lightweight oils or greases made for fishing reels. Apply oil to all bearings, the crank shaft, and the worm gear. Apply grease to the bushings, pinion gears, drive gears, and crank gears.

After usage your reel should be inspected for dirt or sand and cleaned if excessive buildup is present. If your reel has come in contact with saltwater it is important to flush all parts with water, dry and re-lubricate your reel. Through diligent cleaning and maintenance your Lew's[®] reel will provide you with years of reliability and sound performance

fig 1 To remove side cover unscrew side-plate screws pry front cover away from body to access components

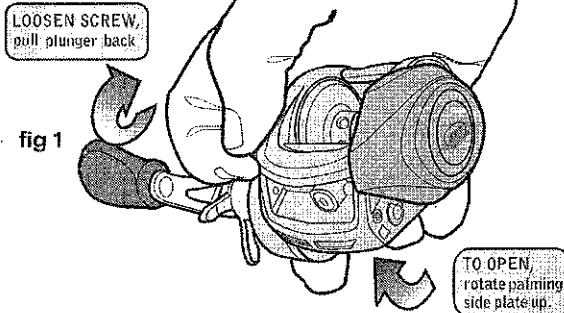

For professional cleaning and maintenance send your reel postage prepaid to:

LEW'S[®] 2253 E. Bennett St. Springfield, MO 65804
877-470-5397 www.lews.com

Lew's[®] warrants its products¹ to withstand normal² use for the purpose designed and intended when manufactured for a period of one (1) year from the original retail sale date to the original retail consumer. Lew's[®] will at its option repair or replace³ Lew's[®] products when required for the warranty period and return⁴ the product to the owner at no additional⁵ cost to the owner.

¹Numerous products have been manufactured under variations of the Lew's[®] name and under the Lew's[®] Logo by multiple businesses over the past 50 years. This warranty is specifically for products manufactured on behalf of Lew's[®] of Springfield, Missouri USA since January 1, 2010. Lew's[®] products manufactured by or on behalf of other entities prior to January 1, 2010 are not covered by this warranty. In all circumstances, this Warranty is Limited in Value to the original retail value of the product and is limited to actual damage to the Lew's[®] product and only the Lew's[®] product. ²Loss of a product, and loss/damage of a product or parts due to the attempted repair or servicing of a Lew's[®] product by any person or business other than Lew's[®] or Lew's[®] Authorized Warranty Service Agent, and damage caused by or resulting from abuse, misuse, lack of recommended maintenance, accident, acts of God, and shipping damages occurring in transit to Lew's[®] or Lew's[®] Authorized Agent are outside the scope of Lew's[®] Limited Warranty and will be repaired through Lew's[®] after warranty services at the expense of the consumer. ³Any products replaced by Lew's[®] will be new or remanufactured by a Lew's[®] Authorized Agent with the same or next model upgrade product. ⁴Lew's[®] will return warranted products to the consumer by reasonable means as determined by Lew's[®]. ⁵Express or expedited services are the responsibility of the consumer as is sending the product to Lew's[®] or Lew's[®] Authorized Agent, for Warranty Service. Lew's[®] and Lew's[®] Service Agents as authorized by Lew's[®] are the sole agents authorized to repair or replace Lew's[®] products under the terms of this warranty. Only written changes by an officer of Lew's[®] can alter the terms or conditions of this warranty.

This warranty gives you specific legal rights including additional rights extended by some states which do not allow certain exclusions and limitations. Any action brought against Lew's[®] for the purpose of settling a warranty dispute shall be brought and litigated in the State of Missouri, County of Greene.

Lew's[®] 2253 E Bennett, Springfield, MO 65804 Phone 1-417-881-LEWS (5397) FAX: 1-417-881-5397

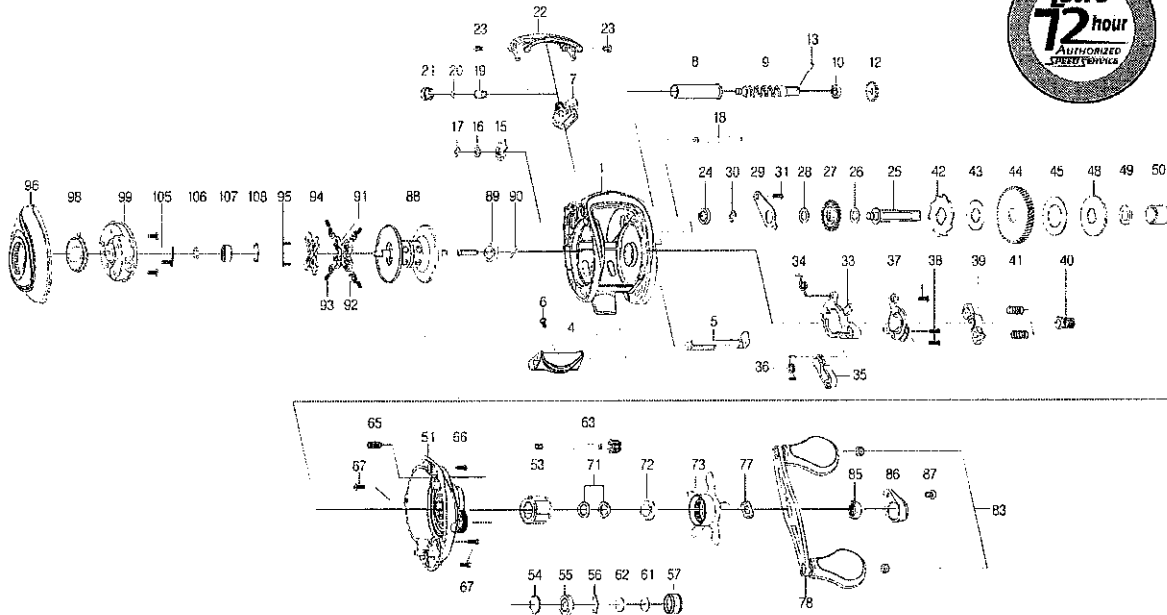

KEY#	PART NAME	KEY#	PART NAME	KEY#	PART NAME
1	FRAME	36	KICK LEVER SPRING	83	HANDLE KNOB CAP (*2)
4	CLUTCH BAR	37	CAM PLATE	85	HANDLE NUT
5	CLUTCH LINK	38	CAM PLATE SCREW (*3)	86	HANDLE NUT CAP
6	CLUTCH BAR SCREW	39	PINION YOKE	87	HANDLE NUT CAP SCREW
7	LEVEL WIND ASSEMBLY	40	PINION GEAR	88	SPOOL ASSEMBLY
8	PIPE	41	PINION YOKE SPRING (*2)	89	BALL BEARING
9	WORM SHAFT	42	RATCHET	90	PIN
10	BALL BEARING	43	RATCHET WASHER	91	BRAKE HOLDER
12	IDLER (S)	44	DRIVE GEAR	92	BRAKE SHOE(*4)
13	WORM SHAFT PIN	45	DRAG WASHER (L)	93	BRAKE SHOE SPRING(*4)
15	WORM SHAFT BUSHING	48	DRAG WASHER (D)	94	BRAKE HOLDER PLATE
16	WORM SHAFT WASHER	49	SLEEVE WASHER (OPTIONAL)	95	BRAKE HOLDER PLATE SCREW(*2)
17	E-RING	50	SLEEVE	96	PALM SIDE COVER
18	PILLAR	51	GEAR SIDE COVER	98	DECORATOR
19	LEVEL WIND PIN	53	ONE WAY CLUTCH	99	SPOOL COVER
20	SPACER(OPTIONAL)	54	O-RING	105	SPOOL COVER SCREW (*3)
21	LEVEL WIND NUT	55	BALL BEARING	106	SPOOL SPACER
22	FRONT COVER	56	BEARING RETAINER	107	BALL BEARING
23	FRONT COVER SCREW (*2)	57	CAST CONTROL CAP	108	BEARING RETAINER
24	BALL BEARING	61	TENSION WASHER		
25	CRANK SHAFT	62	SPOOL SPACER (S)		
26	IDLER (L) WASHER (A)	63	THUMB SCREW		
27	IDLER (L)	66	THUMB SCREW SPRING		
28	IDLER (L) WASHER (B)	66	GEAR SIDE COVER SCREW (A)		
29	BEARING PLATE	67	GEAR SIDE COVER SCREW (B*3)		
30	E-RING	71	DRAG SPRING WASHER (*2)		
31	BEARING PLATE SCREW	72	DRAG SPACER		
33	CLUTCH CAM	73	STAR DRAG		
34	CLUTCH SPRING	77	LEAF SPRING		
35	KICK LEVER	78	HANDLE ASSEMBLY		

LEW'S LASER SPEED SPOOL®

LS1HA

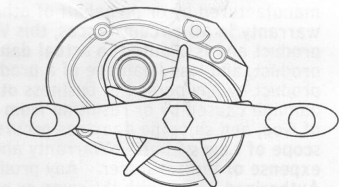

Speed Spool Bait Cast reels are designed to be **Lighter, Faster and Stronger**

Driven by innovation – Fueled with Passion
Feel the Difference!

LASER SPEED SPOOL®

Reel Specifications

Model	Weight	Gear Ratio	Max Drag	Line Capacity	IPT
LS1HA	7.2 oz.	6.4:1	10 lb.	12 lb./120 yds.	28"

FEATURES:

- One-piece Lightweight Graphite Frame
- Zero-Reverse One-way Stainless Steel Clutch Bearing
- 6 Bearing System (5+1)
- Extremely Adjustable Magnetic Brake System
- Machined Aluminum Spool
- Durable Rulon Drag System with up to 10 lbs. Drag Power
- Aluminum Handle

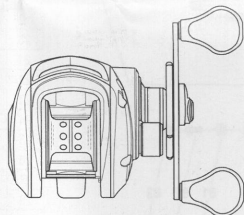

Designed Performance

Our new bait-cast reel by Lew's is designed for performance and functionality. From the way it conforms to your hand, to the way it reacts crisply and effortlessly to your command, you'll know the minute you grab onto the Speed Spool® that you've got a quality reel.

Your Speed Spool® reel exploits several new developments which will allow you to set yourself apart from the competition.

High Strength Brass Gearing

The drive gear, crankshaft, and worm shaft are made of high strength brass for increased strength and durability. In addition to these advantages, brass provides exceptionally low friction to enhance efficiency.

Lightweight Graphite Frame

The one-piece graphite frame design makes this reel lightweight, yet still very strong.

Lightweight Machined Aluminum Spool

Machined Aluminum Spool 

The spool on your Lew's reel has been engineered to maximize casting distance. Anodized to withstand oxidation and abrasion, the lightweight machined aluminum spool with drilled holes to further reduce inertial mass will allow you to propel your lure farther than the competition – and you'll have a greater degree of control with less standing between you and the fish.

Anti-reverse Bearing

The handle on your Speed Spool® reel will only rotate forward for rock solid hook setting power. When you release the handle it will hold its position because of anti-reverse bearings, never losing an inch on your catch; an invaluable property to have when you're pulling it in.

6 Bearings System

Full-release Magnetic Control System

Magnetic Control System **MCS**

In order to combat backlash your Speed Spool® reel is furnished with an externally adjustable, full-release magnetic braking system. As the spool accelerates it experiences magnetic resistance, which can be controlled with a dial on the palming side-plate. A full-release magnetic brake has the ability to be backed far enough away from the spool to completely negate any effect on the acceleration of the spool.



Cast Control System

A second feature exists to prevent backlash, the Cast Control System. An adjustment knob is found next to the star drag. The function saddles the spool shaft with steady pressure in order to stabilize spool speed.

To calibrate the system reel your lure in until it rests on the tip of the rod, then tighten the knob until taut. Depress the thumb bar, and holding the rod horizontally loosen the knob slowly until the lure begins to descend. The spool should continue to spin after the lure contacts the ground, but should not complete more than one full rotation. If the spool does not continue to spin, the knob is too tight. If the spool completes more than one rotation, the knob is too loose. Repeat until you have achieved the desired results.

LASER[®] SPEED SPOOL[®] LSIHA

One Year Limited Warranty

Maintenance and Care

To remove the plating side plate, loosen screw, pull plunger back then rotate palming side plate up. When applying lubricant to your Speed spool[®] reel, avoid using multi-purpose oil. Use lightweight oils or greases made for fishing reels. Apply oil to all bearings, the crank shaft, and the worm gear. Apply grease to the bushings, pinion gears, drive gears, and crank gears.

After usage your reel should be inspected for dirt or sand and cleaned if excessive buildup is present. If your reel has come in contact with saltwater it is important to flush all parts with water, dry and re-lubricate your reel. Through diligent cleaning and maintenance your Lew's[®] reel will provide you with years of reliability and sound performance

fig 1 To remove side cover unscrew side-plate screws pry front cover away from body to access components

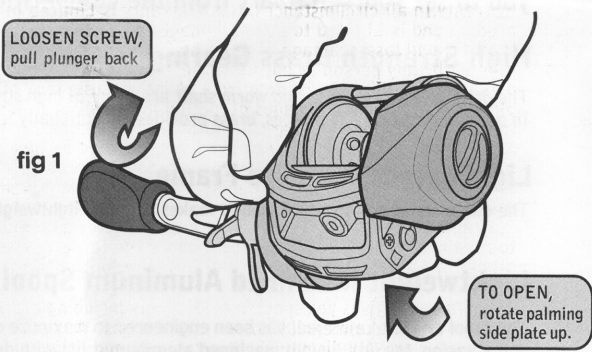

fig 1

For professional cleaning and maintenance send your reel postage prepaid to:

LEW'S[®] 2253 E. Bennett St. Springfield, MO 65804
877-470-5397 www.lews.com

Lew's warrants its products¹ to withstand normal² use for the purpose designed and intended when manufactured for a period of one (1) year from the original retail sale date to the original retail consumer. Lew's will at its option repair or replace³ Lew's products when required for the warranty period and return⁴ the product to the owner at no additional⁵ cost to the owner.

¹Numerous products have been manufactured under variations of the Lew's name and under the Lew's Logo by multiple businesses over the past 50 years. This warranty is specifically for products manufactured on behalf of Lew's of Springfield, Missouri USA since January 1, 2010. Lew's products manufactured by or on behalf of other entities prior to January 1, 2010 are not covered by this warranty. In all circumstances, this Warranty is Limited in value to the original retail value of the product and is Limited to actual damage to the Lew's product and only the Lew's product. ²Loss of a product, and loss / damage of a product or parts due to the attempted repair or servicing of a Lew's product by any person or business other than Lew's or Lew's Authorized Warranty Service Agent, and damage caused by or resulting from abuse, misuse, lack of recommended maintenance, accident, acts of God, and shipping damages occurring in transit to Lew's or Lew's Authorized Agent are outside the scope of Lew's Limited Warranty and will be repaired through Lew's after warranty services at the expense of the consumer. ³Any products replaced by Lew's will be new or remanufactured by a Lew's Authorized Agent with the same or next model upgrade product. ⁴Lew's will return warranted products to the consumer by reasonable means as determined by Lew's. ⁵Express or expedited services are the responsibility of the consumer as is sending the product to Lew's or Lew's Authorized Agent, for Warranty Service. Lew's and Lew's Service Agents as authorized by Lew's are the sole agents authorized to repair or replace Lew's products under the terms of this warranty. Only written changes by an officer of Lew's can alter the terms or conditions of this warranty.

This Warranty gives you specific legal rights including additional rights extended by some States which do not allow certain exclusions and limitations. Any action brought against Lew's for the purpose of settling a warranty dispute shall be brought and litigated in the State of Missouri, County of Greene.

Lew's - 2253 E Bennett - Springfield, MO 65804 - Phone 417-881-LEWS (5397) - FAX 417-881-5387

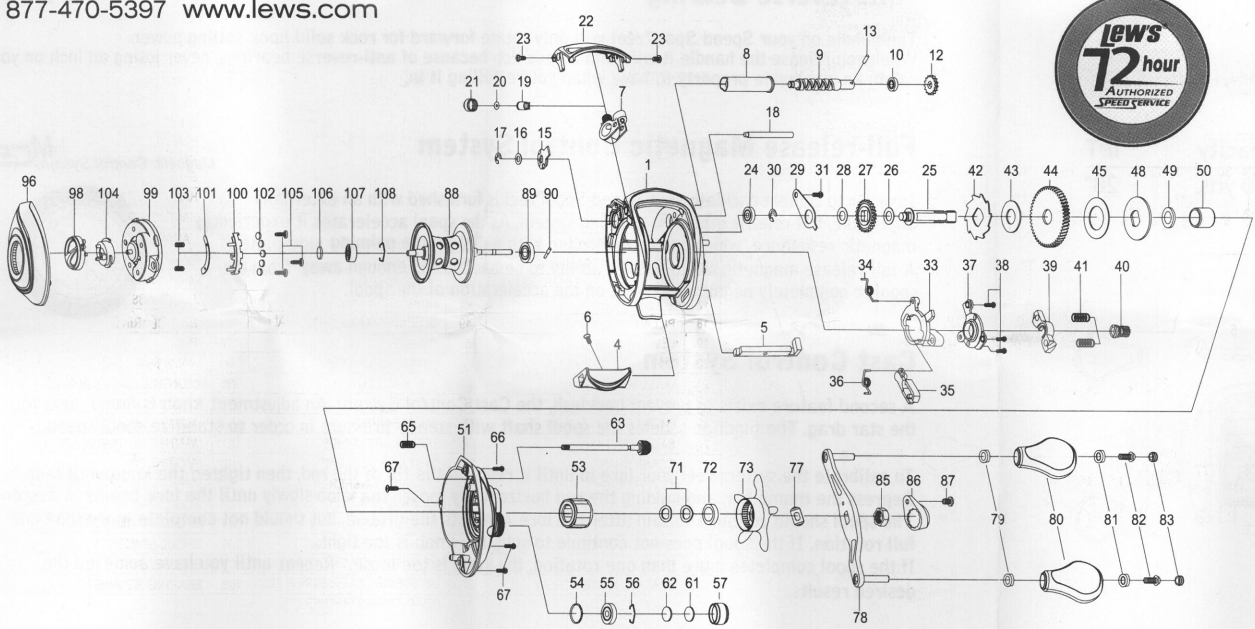

Key#	Part Name	Key#	Part Name	Key#	Part Name
1	FRAME	34	CLUTCH SPRING	72	DRAG SPACER
4	CLUTCH BAR	35	KICK LEVER	73	STAR DRAG
5	CLUTCH LINK	36	KICK LEVER SPRING	77	LEAF SPRING
6	CLUTCH BAR SCREW	37	CAM PLATE	78	HANDLE ASSEMBLY
7	LEVEL WIND ASSEMBLY	38	CAM PLATE SCREW(*3)	79	BEARING (*2)
8	PIPE	39	PINION YOKE	80	HANDLE KNOB (*2)
9	WORM SHAFT	40	PINION GEAR	81	BEARING (*2)
10	BALL BEARING	41	PINION YOKE SPRING(*2)	82	HANDLE KNOB SCREW (*2)
12	IDLER(S)	42	RATCHET	83	HANDLE KNOB CAP (*2)
13	WORM SHAFT PIN	43	RATCHET WASHER	85	HANDLE NUT
15	WORM SHAFT BUSHING	44	DRIVE GEAR	86	HANDLE NUT CAP
16	WORM SHAFT WASHER(OPTIONAL)	45	DRAG WASHER (L)	87	HANDLE NUT CAP SCREW
17	E-RING	48	DRAG WASHER (D)	88	SPOOL ASSEMBLY
18	PILLAR	49	SLEEVE WASHER(OPTIONAL)	89	BALL BEARING
19	LEVEL WIND PIN	50	SLEEVE	90	PIN
20	SPACER(OPTIONAL)	51	GEAR SIDE COVER	96	PALM SIDE COVER
21	LEVEL WIND NUT	53	ONE WAY CLUTCH	98	CONTROL DIAL ASSEMBLY
22	FRONT COVER	54	O-RING	99	SPOOL COVER
23	FRONT COVER SCREW (*2)	55	BALL BEARING	100	MAGNET HOLDER
24	BALL BEARING	56	BEARING RETAINER	101	MAGNET HOLDER PLATE
25	CRANK SHAFT	57	CAST CONTROL CAP	102	MAGNET (*5)
26	IDLER(L) WASHER (A)	61	TENSION WASHER	103	MAGNET HOLDER SPRING (*2)
27	IDLER(L)	62	SPOOL SPACER (B)	104	SLIDE CAM
28	IDLER(L) WASHER (B)	63	THUMB SCREW	105	SPOOL COVER SCREW (*3)
29	BEARING PLATE	65	THUMB SCREW SPRING	106	SPOOL SPACER
30	E-RING	66	GEAR SIDE COVER SCREW (A)	107	BALL BEARING
31	BEARING PLATE SCREW	67	GEAR SIDE COVER SCREW (B*3)	108	BEARING RETAINER
33	CLUTCH CAM	71	DRAG SPRING WASHER (*2)		